

SET UP

STAND UP UNIVERSAL COUNTER



PORTABLE DISPLAYS



Take the frame out of the bag and fold out the back and front.



Continue to unfold the system by pushing the end sides outwards.

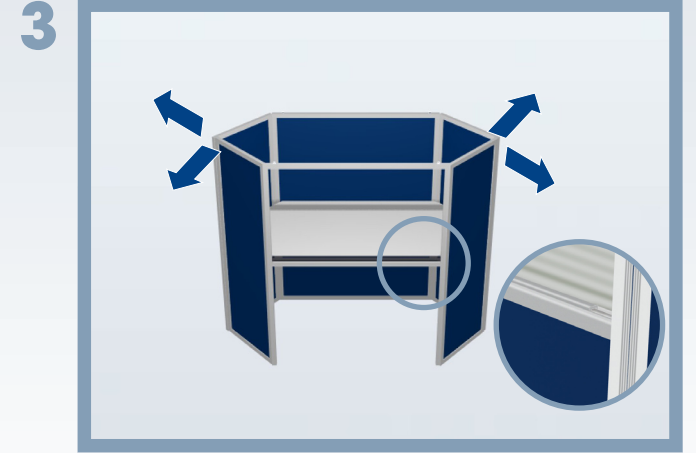

Mount the internal shelf by fine-tuning the shape of the structure. Lock the structure by allowing the hooks at the front and rear of the shelf to fall into the slots on the system's shelf rests.

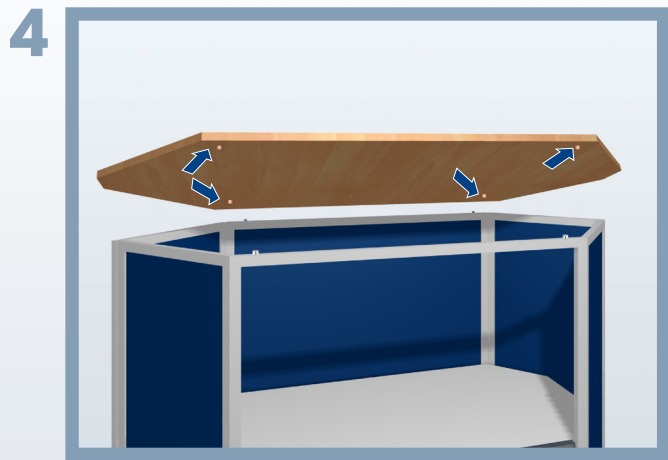

Place top shelf and fix its position by allowing the four screws to go into the holes on the lower surface of the top shelf.



Place the counter on a level surface as possible and check the stability.



Ready!

